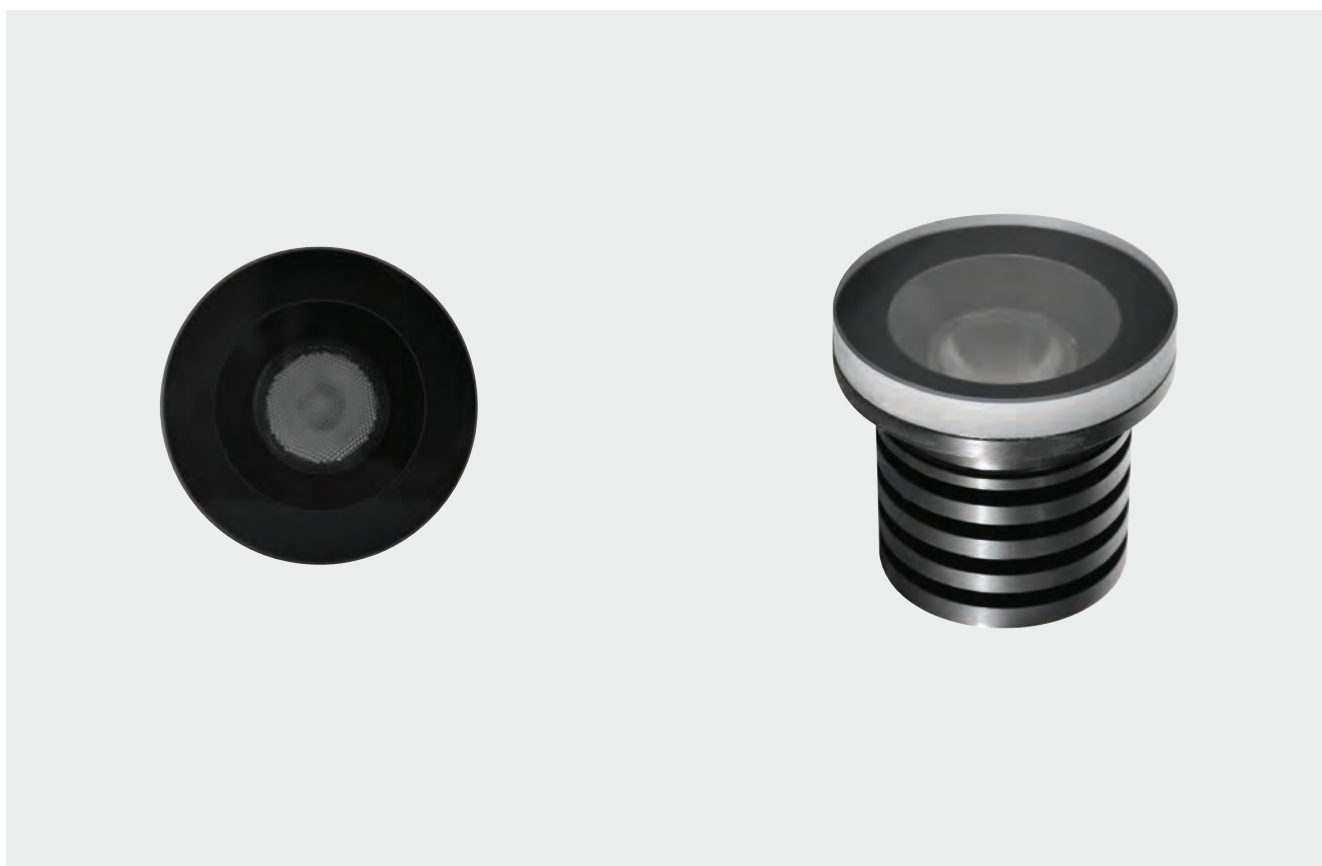

PLTR70

CE IP67 CLIII **Installation**

"All glass" recessed walkover luminaire for indoor and outdoor installation. The deep recessed LED guarantees a lower glaring.

Technical description

Body, machined and black anodized aluminum.
Front closure made of clear tempered glass.
High quality LED from Cree or Lumileds.

Electrical features

Remote power supply not included.
Class III luminaire.

**Wiring**

Luminaire supplied with 40 cm
2X0,5mmq outdoor cable with
anticondenstation system on cable.

Source type

Multichip LED

Luminaire wattage

5.5W - 7.8W

Colour temperature

2700K - 3000K - 4000K

CRI

>80 - on request >90

Beam angle

12° - 21° - 26° - 45° - 65° - Opal

Driver

Remote

Input current

Max 700 mA

Protection class

CLIII

IP rating

IP67

Weight

0.3 kg

Dimensions

Ø 70 X h 71

**APLT70F01 - Recessed housing**

Housing for recessed installation made of plastic material and supplied with a cap to be removed after concrete casting and before luminaire installation.

PLTR70 5.5W

CE IP67 CLIII

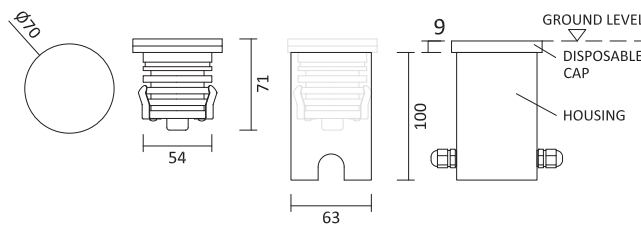

Product codes

Code	W	Optic	Lm	K	CRI
APLT70F10Y	5.5	12°	460	2700	80
APLT70F10W	5.5	12°	495	3000	80
APLT70F10N	5.5	12°	525	4000	80
APLT70F11Y	5.5	21°	535	2700	80
APLT70F11W	5.5	21°	570	3000	80
APLT70F11N	5.5	21°	605	4000	80
APLT70F12Y	5.5	26°	530	2700	80
APLT70F12W	5.5	26°	565	3000	80
APLT70F12N	5.5	26°	600	4000	80
APLT70F13Y	5.5	45°	470	2700	80
APLT70F13W	5.5	45°	500	3000	80
APLT70F13N	5.5	45°	535	4000	80
APLT70F14Y	5.5	65°	465	2700	80
APLT70F14W	5.5	65°	495	3000	80
APLT70F14N	5.5	65°	525	4000	80
APLT70F17Y	5.5	OPAL	300	2700	80
APLT70F17W	5.5	OPAL	320	3000	80
APLT70F17N	5.5	OPAL	345	4000	80

+ Power supply codes

Code	Description
.ST0500	Standard - 500 mA
.DI0500	DIM1-10 - 500 mA
.DA0500	DIM DALI - 500 mA

21° 5.5W

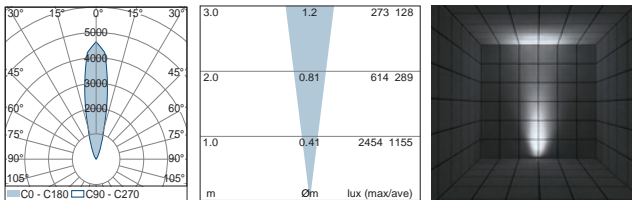

26° 5.5W

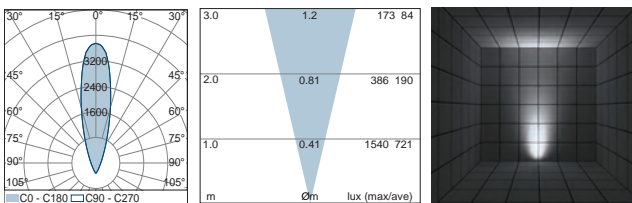

45° 5.5W

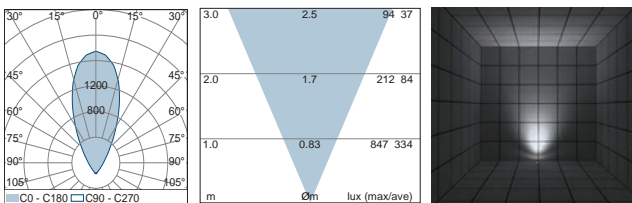

65° 5.5W

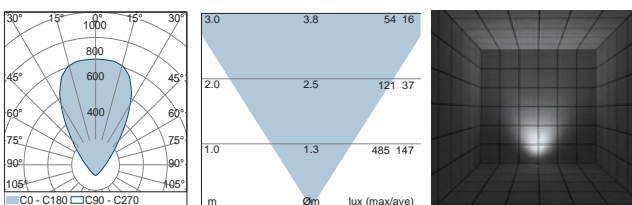

RGBW version available

RGBA version available

Dynamic warm white version available

Dynamic white version available

PLTR70 7.8W

CE IP67 CLIII 

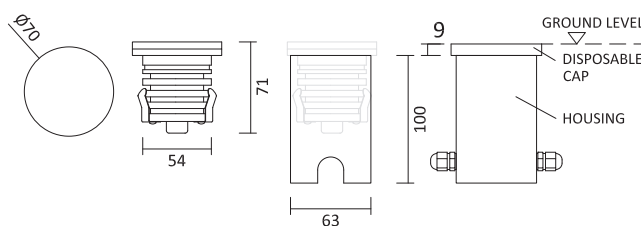

Product codes

Code	W	Optic	Lm	K	CRI
APLT70F20Y	7.8	12°	620	2700	80
APLT70F20W	7.8	12°	660	3000	80
APLT70F20N	7.8	12°	700	4000	80
APLT70F21Y	7.8	21°	715	2700	80
APLT70F21W	7.8	21°	760	3000	80
APLT70F21N	7.8	21°	805	4000	80
APLT70F22Y	7.8	26°	705	2700	80
APLT70F22W	7.8	26°	750	3000	80
APLT70F22N	7.8	26°	800	4000	80
APLT70F23Y	7.8	45°	630	2700	80
APLT70F23W	7.8	45°	665	3000	80
APLT70F23N	7.8	45°	710	4000	80
APLT70F24Y	7.8	65°	620	2700	80
APLT70F24W	7.8	65°	660	3000	80
APLT70F24N	7.8	65°	705	4000	80
APLT70F27Y	7.8	OPAL	470	2700	80
APLT70F27W	7.8	OPAL	500	3000	80
APLT70F27N	7.8	OPAL	530	4000	80

+ Power supply codes

Code	Description
.ST0700	Standard - 700 mA
.DI0700	DIM1-10 - 700 mA
.DA0700	DIM DALI - 700 mA

21° 7.8W

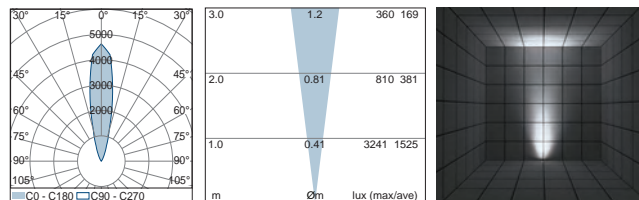

26° 7.8W

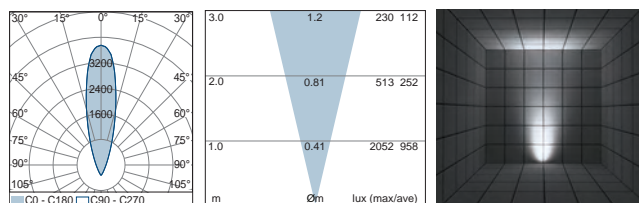

45° 7.8W

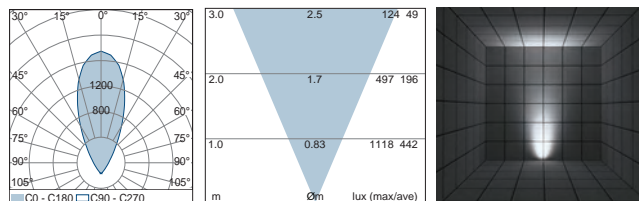

65° 7.8W

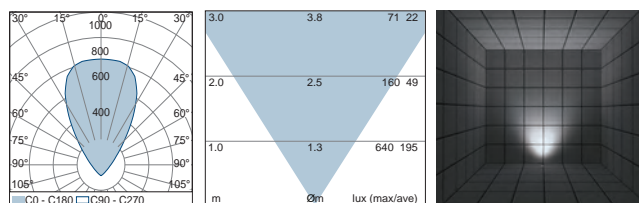

RGBW version available 

RGBA version available 

Dynamic warm white version available 

Dynamic white version available 